

Kit 1013

RENAULT Clio, 3-dr Hatchback, 91-97

RENAULT Clio, 5-dr Hatchback, 91-97

480R
754

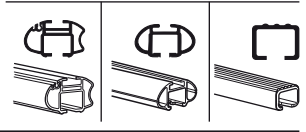
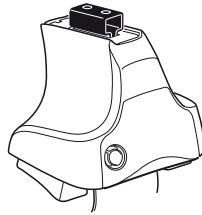

480

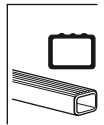
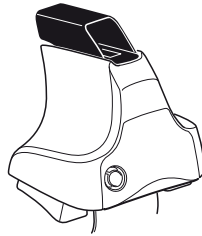

750

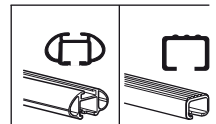
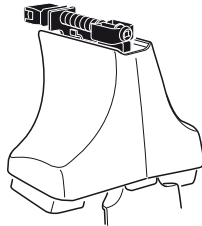

xx kg / xx lbs + 7 kg / 15,4 lbs = **Max. 50 kg**
Max. 110 lbs
 3 kg / 6,6 lbs

80 km/h 50 Mph 130 km/h 80 Mph
 40 km/h 25 Mph
km/h Mph

THULE + **Kit XXXX**

x1 x4 x4 x4 x4
480R/754

x1 x4 x4 x4
480

x1 x4 x4
750

x2	x2	x2	x2	x2
x2	x2	x2	x2	x2
x2	x2	x2	x2	x2
x4	x4	x4	x4	x4

009 x4 **16** x4 **x1**

Kit





1

2

	X
RENAULT Clio, 3-dr Hatchback, 91-97	22,5
RENAULT Clio, 5-dr Hatchback, 91-97	22,5

1

2

	Y
RENAULT Clio, 3-dr Hatchback, 91-97	20,5
RENAULT Clio, 5-dr Hatchback, 91-97	21,5

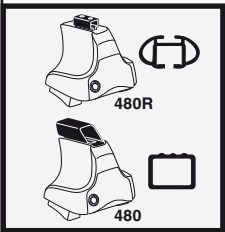

1

2

	X inch	X mm
RENAULT Clio, 3-dr Hatchback, 91-97	34 1/2"	876 mm
RENAULT Clio, 5-dr Hatchback, 91-97	34 1/2"	876 mm

1

2

	Y inch	Y mm
RENAULT Clio, 3-dr Hatchback, 91-97	33 3/8"	856 mm
RENAULT Clio, 5-dr Hatchback, 91-97	34 1/8"	866 mm

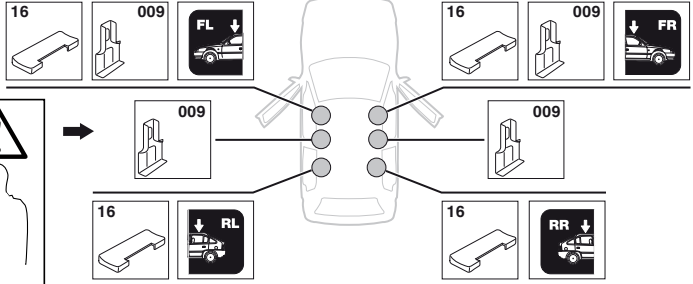
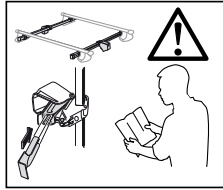
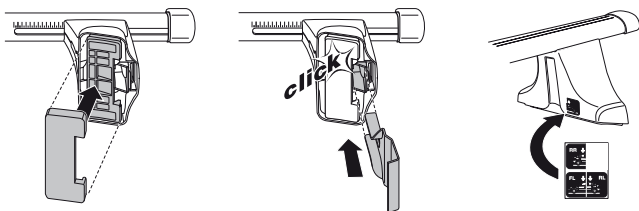
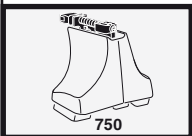
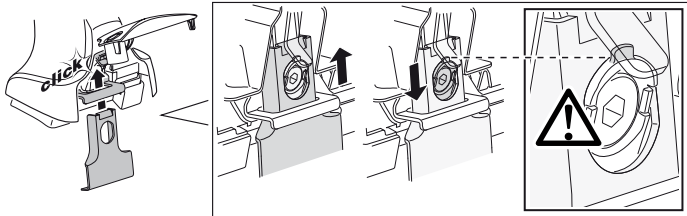
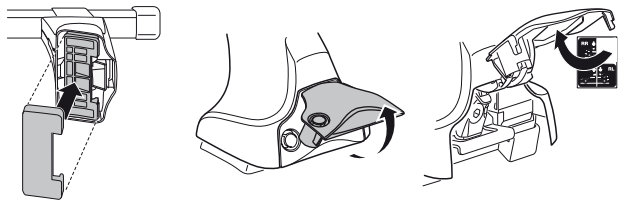
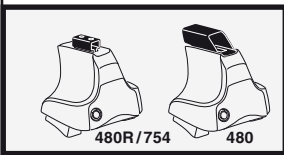
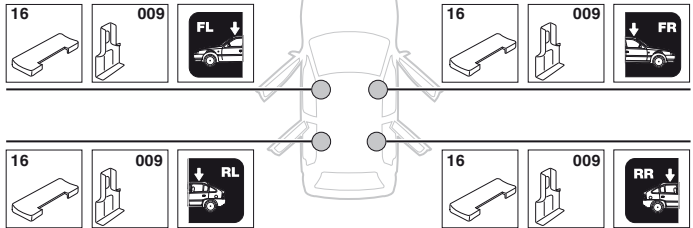
4**RENAULT Clio, 3-dr Hatchback, 91-97****SRA****RENAULT Clio, 5-dr Hatchback, 91-97**

5

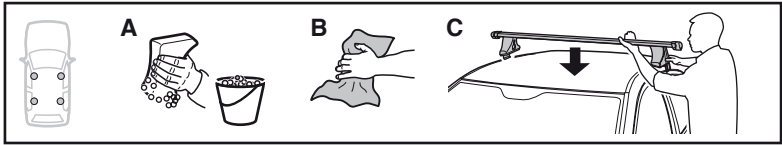

	X mm	Y mm	Z mm	X inch	Y inch	Z inch
RENAULT Clio, 3-dr Hatchback, 91-97	210 mm	700 mm	360 mm	8 1/4"	27 1/2"	14 1/8"
RENAULT Clio, 5-dr Hatchback, 91-97	240 mm	700 mm	-	9 1/2"	27 1/2"	-

RENAULT Clio, 3-dr Hatchback, 91-97

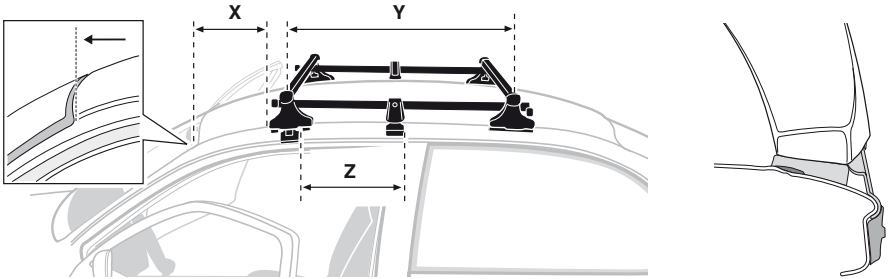

RENAULT Clio, 5-dr Hatchback, 91-97

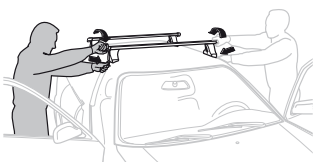
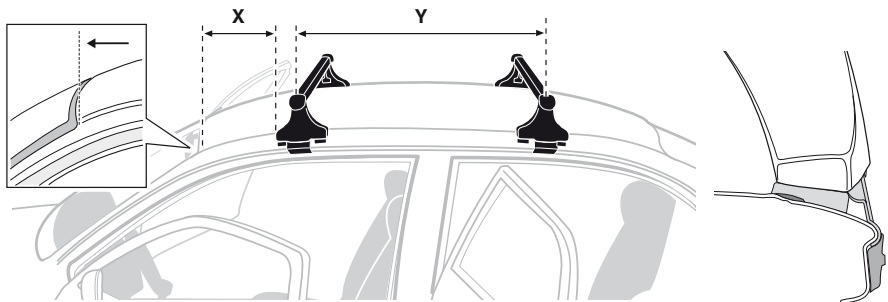

- GB/US Tighten alternately
- D Die Schrauben abwechselnd anziehen
- F Serrer alternativement chaque côté
- NL Afwisselend aan de linker- en de rechterkant aandraaien
- I Alternare il serraggio delle viti
- E Apretar alternativamente
- PT Aperte alternadamente
- S Dra át växelvis
- FIN Kierrä vuorotellen
- EST Pinguldage vaheldumisi
- LAT Pievelciēt pamišus
- LIT Užsukinėkite pakaitomis
- PL Śruby dokręcaj naprzemiennie
- RU Затягивайте попеременно

- CZ Pokręťla багаžníka dokręcaj dokręcaj naprzemiennie.
- SK Dofahujte striedavo
- SLO Privijajte izmenično.
- HR Naizmjenično zategnite
- HU Egymástól fűggetlenül szorítandó
- GR Σφιγγετε εναλλάξ
- TR Dönüşümlü sıkın

中文 交替拧紧

한국어 번갈아 가며 조이십시오.

日本語 交互に締め付けてください。

ไทย ชั้้นในแบบสลับ

6



480R/754



480

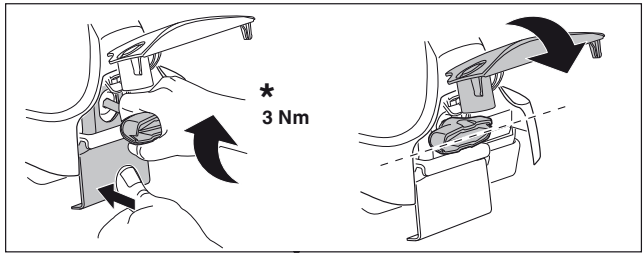
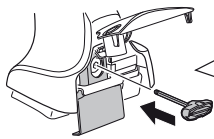

*
3 Nm



*

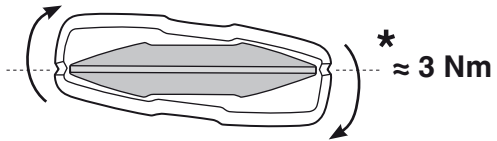

*
≈ 3 Nm

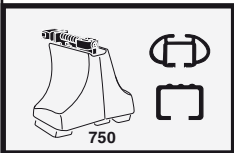
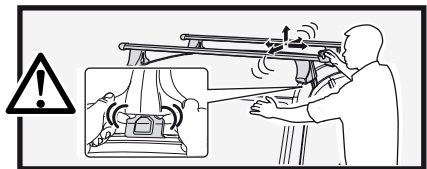

750

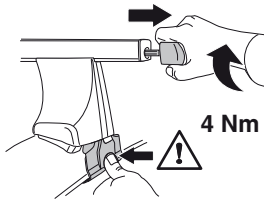

4 Nm

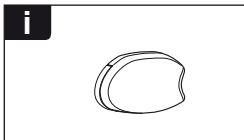
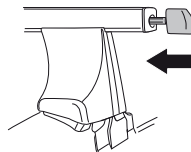

i

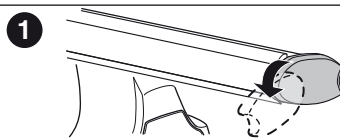

1

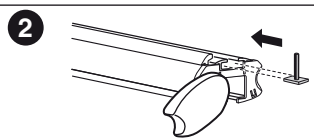

2

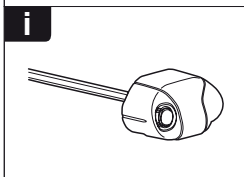

i

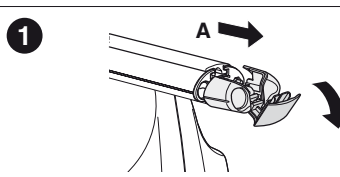

1

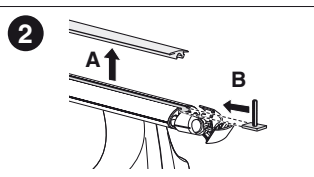

2

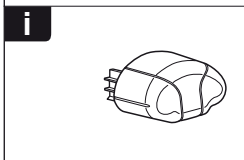

i

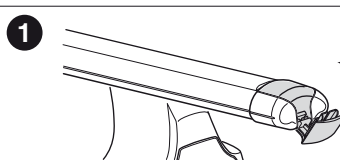

1

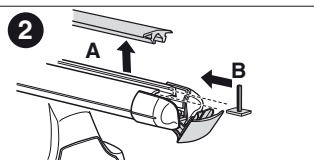

2

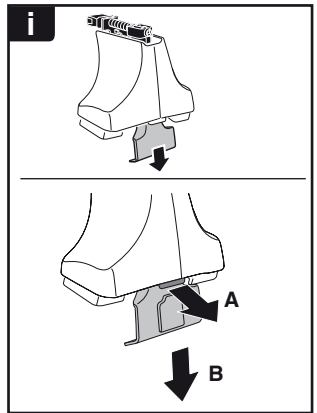

THULE
SWEDEN
**ONE
KEY
SYSTEM**



		544	(x4)
		596	(x6)
		588	(x8)
NA		510	(x10)
EUR		452	(x12)
ASIA			



WW ▶ Thule Sweden AB, Box 69, 330 33 Hillerstorp, SWEDEN
NA ▶ Thule Inc., 42 Silvermine Road, Seymour, Connecticut 06483, USA

info@thule.com
customer.service@thule.com

www.thule.com